

spec ref		dr wadmin, wadm		2006/02/21		projection		size A4		scale 1:1	
tolerance std		eng Koon-Poh Tay		2024/06/10						ecn no ELX-S-51773-1	
ASME Y14.5		chr -		-						rel level Released	
TOLERANCES UNLESS OTHERWISE SPECIFIED		appr Koon-Poh Tay		2024/06/11		product family -		rev T		sheet 1 of 3	
surface		linear		0.X ±----		<b>Amphenol FCI</b> S-ATA COMB RECEPTACLE R/A SMT TYPE ASSY www.fci.com		dwg no 10029364		rev T	
				0.XX ±0.20							
				0.XXX ±----							
		angular		0° ±°		cat. no. -		Product - Customer Drw		sheet 1 of 3	

Creo F119:ELX-MC-AC, REV F, 2020-12-21

10029364-00XLF/TRLF

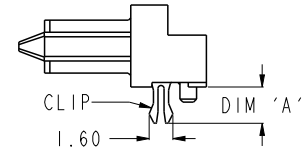
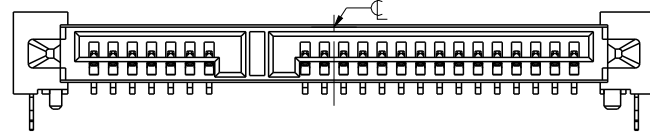

10029364-01XLF/TRLF

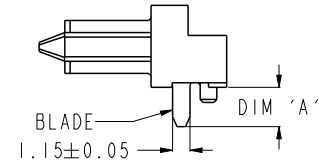
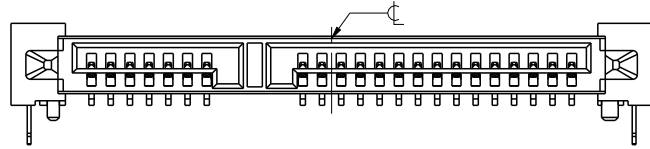

10029364-10XLF/TRLF

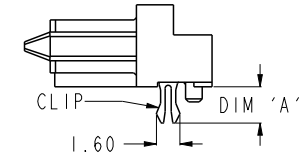
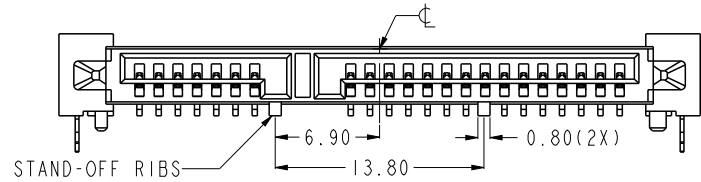

10029364-11XLF/TRLF

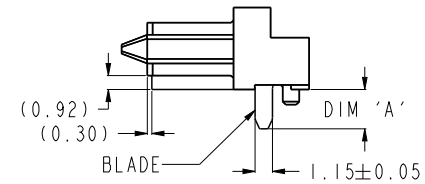
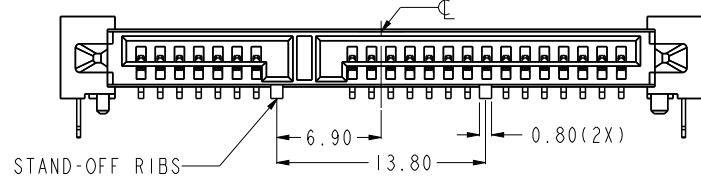

10029364-11XCLEF/C-TRLF

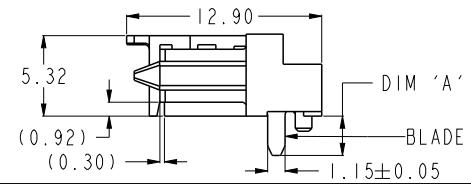
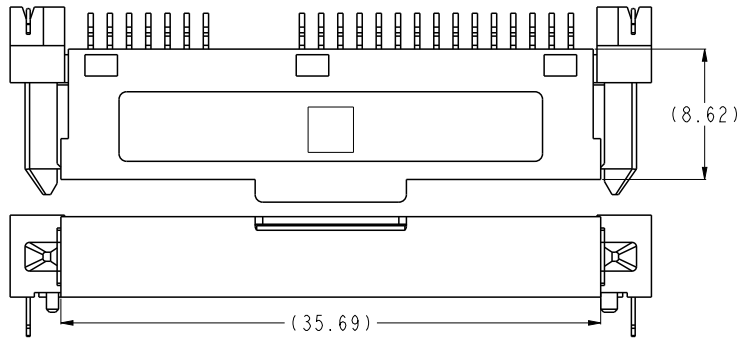

spec ref		dr <b>wcadmin, wcadm</b>		2006/02/21		projection		size A4		scale 1:1	
tolerance std		eng <b>Koon-Poh Tay</b>		2024/06/10				MM		ecn no <b>ELX-S-51773-1</b>	
ASME Y14.5		chr -		-							
TOLERANCES UNLESS OTHERWISE SPECIFIED surface		appr <b>Koon-Poh Tay</b>		2024/06/11		product family		-		rel level <b>Released</b>	
		linear		0.X ±----		<b>Amphenol FCI</b> S-ATA COMB RECEPTACLE R/A SMT TYPE ASSY		dwg no 10029364		rev <b>T</b>	
				0.XX ±0.20							
angular		0° ±°		www.fci.com		cat. no.		-		Product - Customer Drw	
										sheet 2 of 3	

PRODUCT NO.	RECOMMENDED P.C.B. THICKNESS	HOLD DOWN	DIM 'A'	HOUSING WITH STAND-OFF RIBS	PACKAGING	
10029364-001LF	1.60	METAL CLIP	2.40	NO	TRAY	
10029364-001TRLF					TAPE & REEL	
10029364-002LF	1.00		NO	1.80	TRAY	
10029364-002TRLF					TAPE & REEL	
10029364-102LF			TRAY			
10029364-102TRLF			TAPE & REEL			
10029364-011LF	--	BLADE	2.60	NO	TRAY	
10029364-011TRLF					TAPE & REEL	
10029364-111LF			YES	NO	2.60	TRAY
10029364-111TRLF						TAPE & REEL
10029364-111CLF						TRAY
10029364-111C-TRLF						TAPE & REEL

NOTES:-

1. MATERIAL:

- 1) HOUSING : HIGH TEMP. THERMOPLASTIC PA-9T, UL 94V-0  
COLOR : BLACK
- 2) TERMINAL : PHOSPHOR BRONZE
- 3) HOLD DOWN : BRASS

2. FINISH:

- 1) TERMINAL : 30u" GOLD PLATING (CONTACT POINT)  
OVER 50u" MIN NICKEL
- 2) SOLDER TAIL : 100u" MIN TIN OVER 50u" NICKEL
- 3) HOLD DOWN : 100u" MIN TIN OVER 50u" NICKEL

- 3. TRUE POSITION APPLY AT TERMINAL TIP
- 4. THE STANDARD PACKAGING IS IN TRAY.
- 5. THE HOUSING WILL WITHSTAND EXPOSURE TO 260°C PEAK TEMPERATURE FOR 10 SECONDS IN A CONVECTION, INFRA-RED OR VAPOR PHASE REFLOW OVEN

6 THIS PRODUCT MEETS EUROPEAN UNION DIRECTIVES AND OTHER COUNTRY REGULATIONS AS DESCRIBED IN GS-22-008

7 PART NUMBERS ENDING IN "LF" ARE MEANT FOR LEAD-FREE IDENTIFICATION. P/N XXXXXXXX-XXXLF IS EQUIVALENT TO PREVIOUS P/N XXXXXXXX-XXX

8. A SYMBOL WILL BE NEXT TO ANY DIMENSION, VIEW, OR NOTE WHICH HAS BEEN MODIFIED WITH THE CURRENT DRAWING REVISION.

RECOMMENDED P.C.B. LAYOUT  
TOLERANCE UNLESS OTHERWISE ±0.10

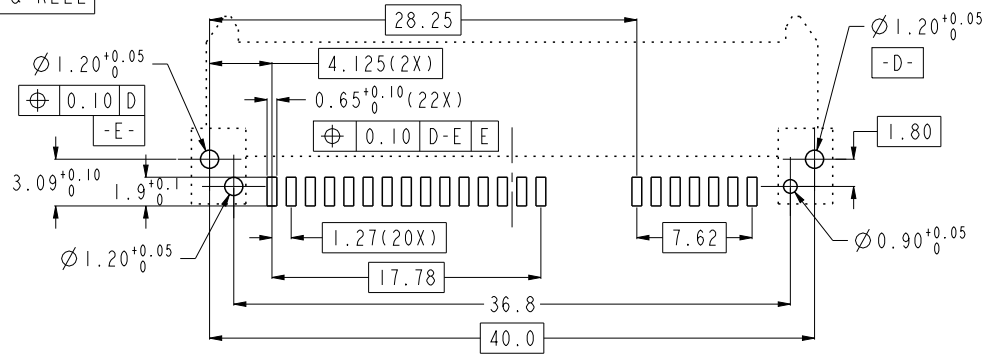

ALTERNATIVE P.C.B. LAYOUT  
REFER TO RECOMMENDED PCB LAYOUT FOR UNSPECIFIED DIMENSIONS  
TOLERANCE UNLESS OTHERWISE ±0.10

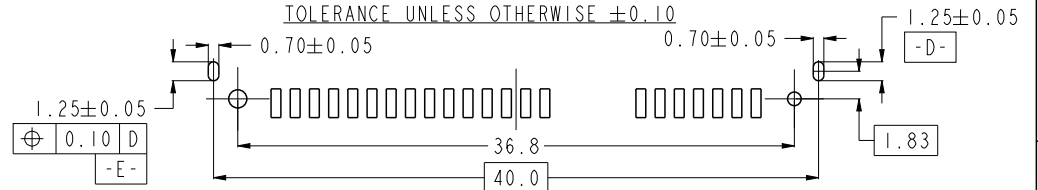

spec ref		dr	wcadmin, wcadm	2006/02/21	projection 	MM 	size	A4	scale	1:1
tolerance std		eng	Koon-Poh Tay	2024/06/10			ecn no	ELX-S-51773-1		
ASME Y14.5		chr	-	-				rel level	Released	
surface	linear	0.X	±----	Amphenol FCI	product family		-	dwg no	10029364	rev
		0.XX	±0.20		S-ATA COMB RECEPTACLE					
		0.XXX	±----		R/A SMT TYPE ASSY					
angular		0°	±°	www.fci.com	cat. no.	-	Product - Customer Drw	sheet 3 of 3		